

PARTS LIST
DC PRO-S

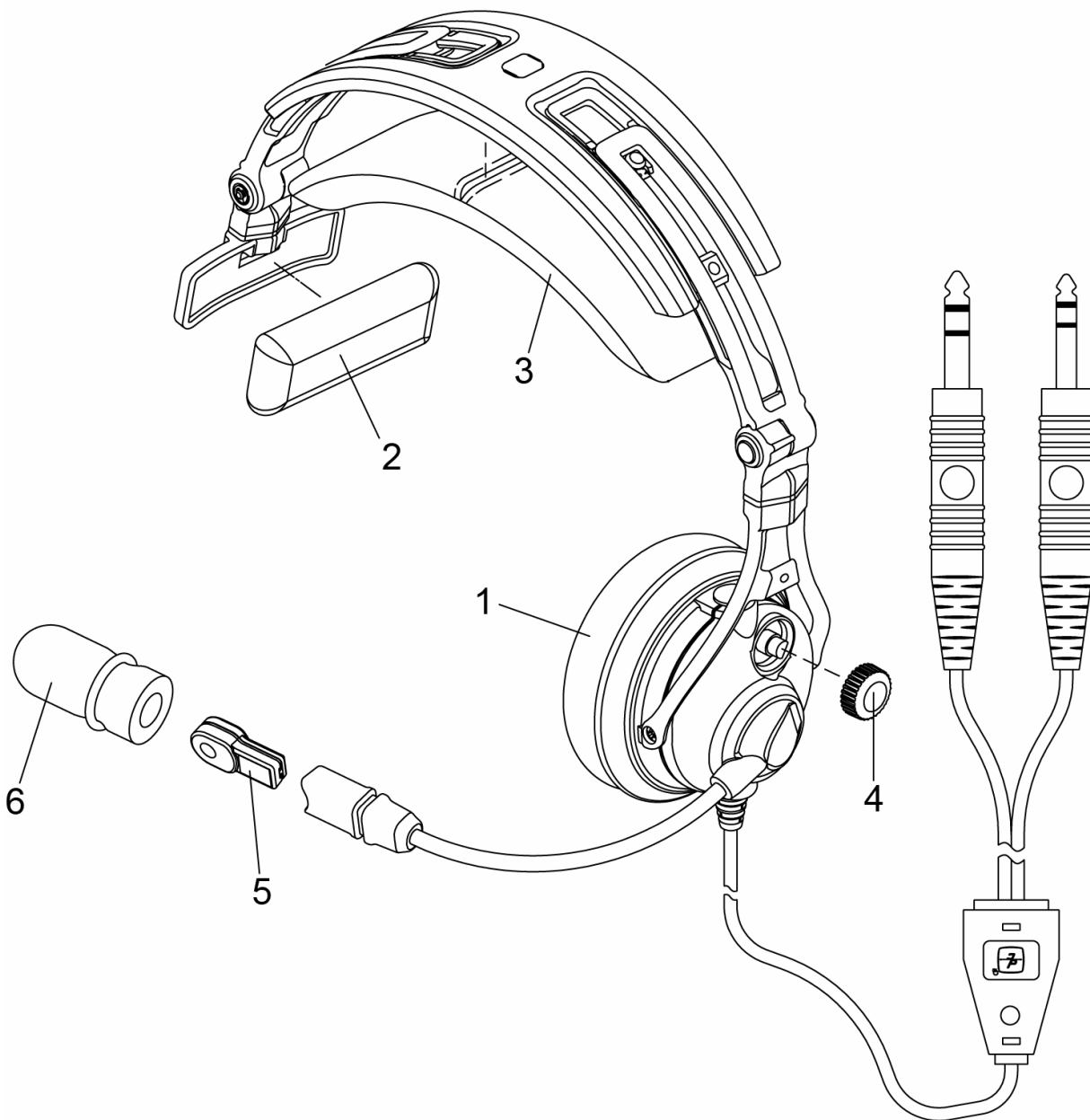

No.	Description	Part No.
1	Earseal	15976P-04
2	Temple Pad	15993G-01
3	Headpad	15977P-04

No.	Description	Part No.
4	Volume Control Knob Assy	40585G-02
5	Microphone M-55	09168P-66
6	Mic Protector w/ O-Ring	40062G-02

DC PRO-S

Usage Instructions

The suspension system on the DC Pro-S is designed for a simple and comfortable fit. Proper fit is necessary for maximum effectiveness. The headset should be worn so that the headpad lightly touches the top of the head. Adjust the sliding assembly on each side as necessary, keeping slide positions equal on either side. For proper microphone placement, adjust boom up/down and in/out by rotating and flexing the boom as necessary. Ideal microphone placement is 1/8" from the lips as this will provide maximum intelligibility and ambient noise rejection.

Replaceable Parts Removal/Installation

- M-55 Microphone (09168P-66) and mic protector (40062G-02)
 - To remove: Gently pull off foam cover. Grasp microphone firmly and pull straight out.
 - To install: Align keyway on microphone with keyway on boom. "TALK" should be inward towards the user's face. Push until microphone snaps into place.

- Earseal (15976P-04)
 - To remove: Gently pull off.
 - To install: Stretch earseal over lip on dome until completely seated on dome.

- Headpad (15977P-04)
 - To remove: Gently pull off.
 - To install: Align headpad with headband assembly and push all around the perimeter to engage hook-and-loop fasteners.

- Temple Pad (15993G-01)
 - To remove: Gently pull off.
 - To install: Align temple pad with temple pad slider assembly and push all around the entire surface to engage hook-and-loop fasteners.