

**PARTS LIST
MODEL HBT-30**

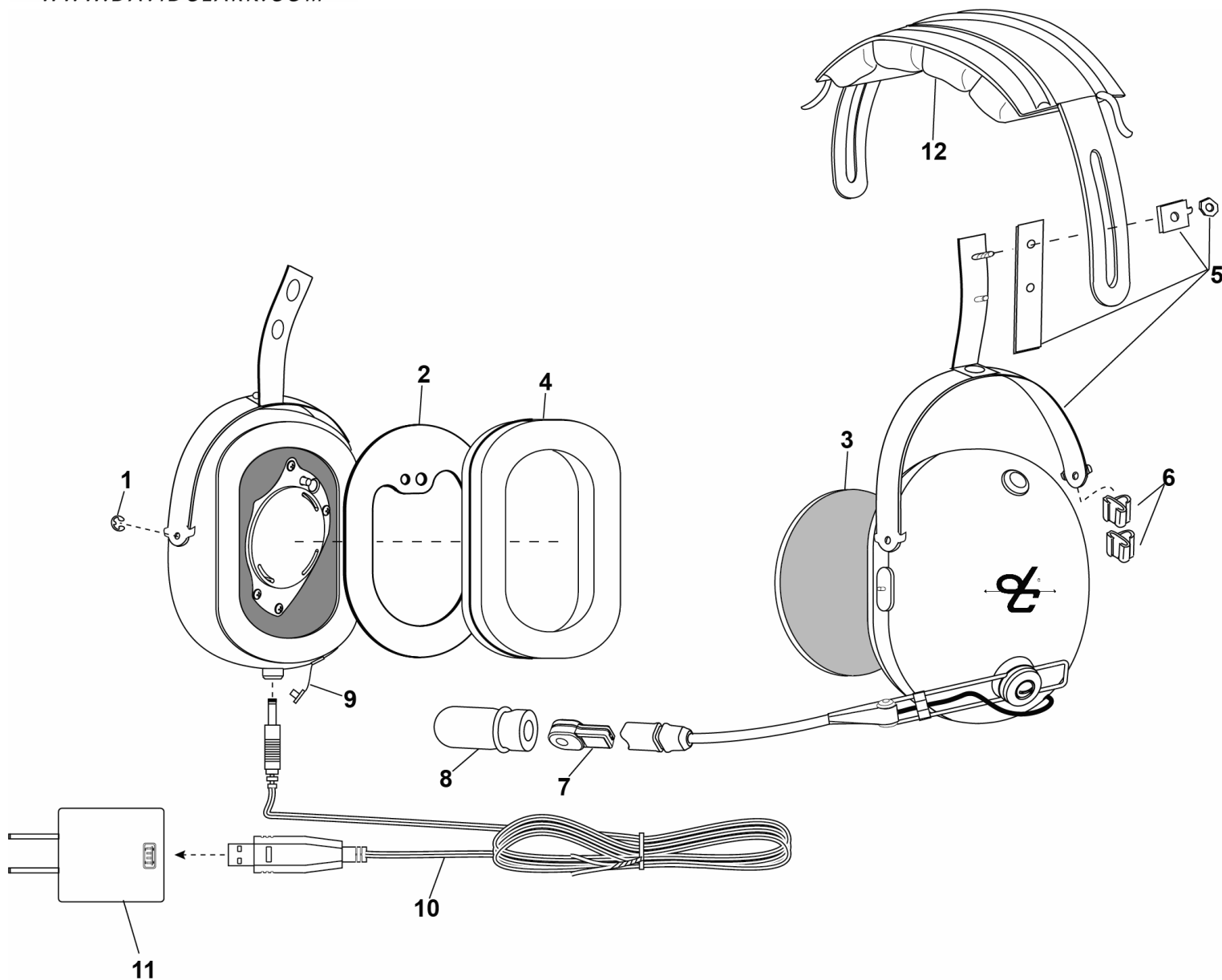

No.	Description	Part No.
1	Retaining Ring (10/pk)	09464P-08
2	Filter (Right)	15512P-04
3	Filter (Left)	15512P-03
4	Undercut Gel Earseal (pair)	40863G-02
5	Stirrup & Clamp Kit	22378G-15
6	Clip, Cord (4/pk)	15350P-02

No.	Description	Part No.
7	Microphone M-55	09168P-66
8	Mic Protector w/ O-Ring	40062G-02
9	Dust Cap	13238P-27
10	Charger Cable	09923P-44
11	AC/DC Adapter	09525P-25
12	Headpad Assy	40075G-02

MODEL HBT-30

Quick Start Guide

The HBT-30 is designed for a simple and comfortable fit. Proper fit of this device is critical to its noise attenuation effectiveness and stability on the head. Adjust the sliding assembly on each side as necessary, keeping slide positions equal on either side.

The use of eyeglasses will reduce the attenuation afforded by this device. Use "Stop Gaps", P/N 12500G-02; they are inexpensive and effective in restoring some of the attenuation.

Ideal microphone placement is 1/8" from the lips as this will provide maximum intelligibility and ambient noise rejection. For proper microphone placement, adjust boom up/down and in/out by rotating and flexing the boom as necessary.

- Pairing
 - o On/Off pairing button (inside dome)
 - o Press & Hold for On/Off until tone heard
 - o Press once for pairing mode. Light goes Red + Blue alternating
 - o Follow the standard pairing procedure for your smartphone, tablet or other Bluetooth device; see the manual for full details.
- Play/Pause-Answer/hang up (button outside of ear cup)
 - o First press to answer call (Play)
 - o Second press to disconnect the call (Pause)
 - o Press and hold to call back the last called

Replaceable Parts Removal/Installation

- M-55 Microphone (09168P-66) and Microphone protector (40062G-02)
 - o To remove: Gently pull off foam cover. Grasp microphone firmly and pull straight out.
 - o To install: Align keyway on microphone with keyway on boom. "TALK" should be inward towards the user's face. Push until microphone snaps into place.
- Earseals (40863G-02)
 - o To remove: Gently pull off.
 - o To install: Stretch earseal over lip on dome until completely seated on dome.
- Headpad (40075G-02)
 - o Remove nut from clamp, one side, and remove headpad by sliding it off from the headband.
 - o Install new headpad.